

Display Chest Freezer 555L - Curved Glass Top

| Chest Freezers



Display Chest Freezer 555L - Curved Glass Top

Chest Freezers

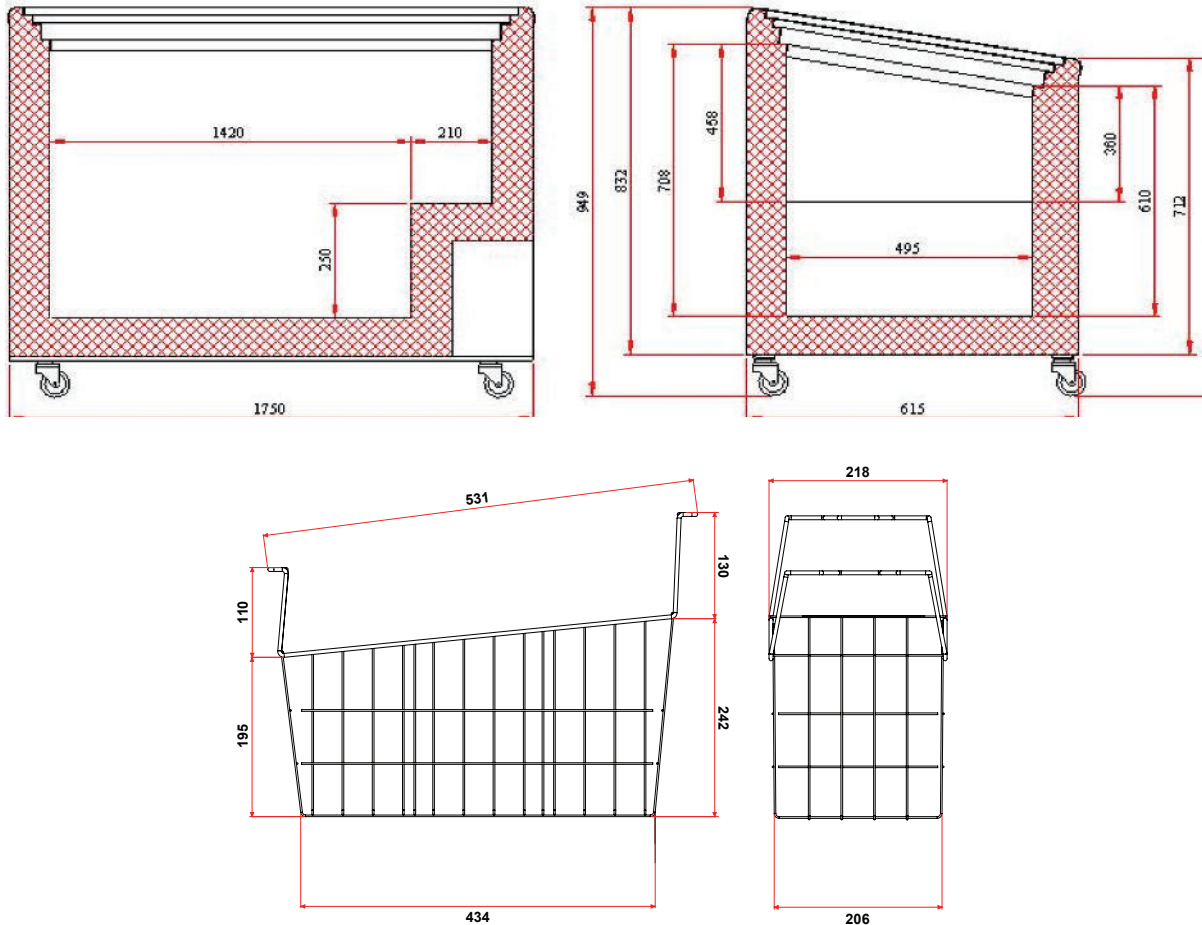

SPECIFICATIONS				DIMENSIONS	
Model Number	CF0600ATCG-NR	Plug Plug	1 x 10A	External (mm)	
Part Number	3736204-NR	Plug Location	Rear, bottom right	Width	1750
Volume	555L	Cord Length	2M	Depth	615
Unit Weight	114kg	Colour	White	Height	949
Packaged Weight	119kg	Internal Light	No	Internal (mm)	
Adjustable Temp. Range	-22°C to -12°C	No. of Lids	2	Width	1630
Max. Ambient Temp.	35°C	Lid Type	Glass	Depth	495
Climate Class	4L1	Lid Shape	Curved	Height	708
Energy Consumption	3.962kWh/24h	Lid Style	Sliding	Packaged (mm)	
GEMS Star Rating	6 Stars	Lid Lock	Yes	Width	1790
Refrigeration Capacity	420W	No. of Baskets	6	Depth	680
Refrigerant	R290	Basket Dimensions	206(w) x 434(d) x 195(h) mm	Height	980
Air Circulation	Static	Defrost System	Manual		
Rated Current	1.5A	Temp. Controller	Analogue controller, digital display		
Electrical Voltage	220-240V	Castors	Yes		
Frequency	50Hz	Warranty	2 Years Bromic Extra Care Warranty - Labour and Parts		
Power Supply	Single Phase				